

# Class 125 • Threaded Cap • Bronze Disc • Threaded Ends

## Swing Check Valve\* Figure B-319C

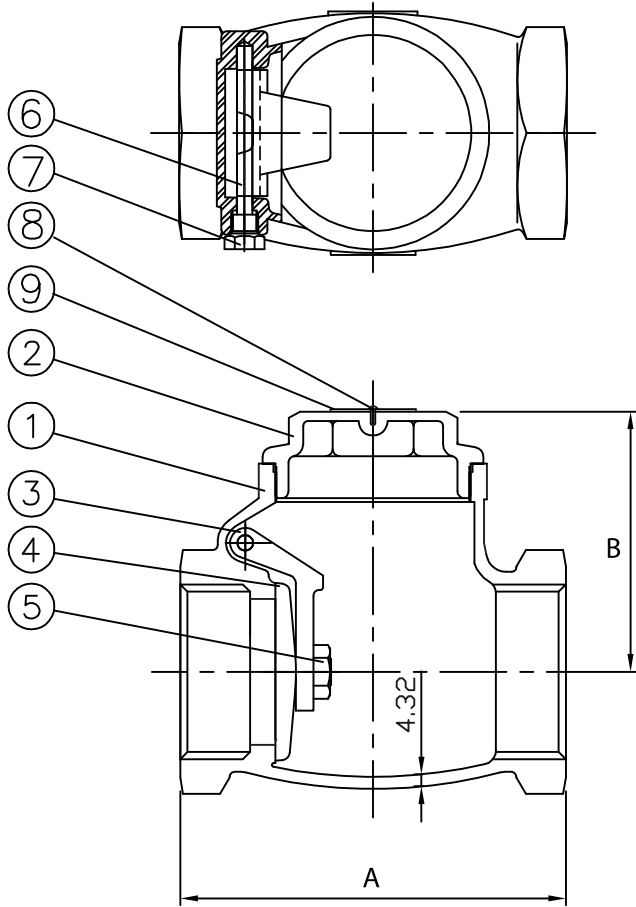

### Materials of Construction

No.	Description	Material	ASTM Spec.
1	Body	Bronze	B-62 C83600
2	Cap	Bronze	B-62 C83600
3	Hanger		B-62 C83600
4	Disc		B-62 C83600
5	Hanger Nut		B-62 C83600
6	Hanger Pin		B-62 C83600
7	Side Plug		B-62 C83600
8	Rivet	Mild Steel	
9	Name Plate	Aluminum	

### Industry Standards

Complies with MSS SP-80 Type 3

See Page 6 for Pressure-Temperature Ratings

### Dimensions and Weights

Inches (millimeters) - Pounds (kilograms)

Valve Size	Dimensions		Wt.
	B	A	
½	1.77	2.59	.66
	(45)	(66)	(.30)
¾	1.92	2.75	.90
	(49)	(70)	(.41)
1	2.28	3.26	1.36
	(58)	(83)	(.62)
1 ¼	2.55	3.77	2.16
	(65)	(96)	(.98)
1 ½	2.87	4.25	3.04
	(73)	(108)	(1.38)
2	3.50	5.03	4.74
	(89)	(128)	(2.15)
2 ½	4.25	6.29	7.71
	(108)	(160)	(3.50)
3	4.84	7.08	9.10
	(123)	(180)	(4.13)

\* Not recommended for use in reciprocating air compressor service.