

MSS-SP-83 UNIONS

Class 3000		1/8	1/4	3/8	1/2	3/4	1	1 1/4	1 1/2	2	2 1/2	3
	A	1 11/16	1 11/16	1 27/32	2	2 5/16	2 7/16	2 7/8	3	3 1/2	4 1/2	4 7/16
	B	1 31/64	1 31/64	1 11/16	1 15/16	2 3/8	2 25/32	3 23/64	3 23/32	4 27/64	5 15/64	6 5/32
	C	53/64	53/64	1	1 3/16	1 15/32	1 25/32	2 7/32	2 35/64	3 1/16	3 9/16	4 9/32
	D	25/32	25/32	31/32	1 3/32	1 5/32	1 3/8	1 45/64	1 7/8	2 1/16	2 3/8	2 7/16
	E	7/16	7/16	7/16	7/16	9/16	9/16	9/16	9/16	11/16	7/8	1
	F	0.42	0.555	0.69	0.855	1.065	1.33	1.675	1.915	2.406	2.906	3.535
	Weight/Union (lbs)	0.38	0.36	0.5	0.695	1.175	1.64	2.59	3.41	5.12	8.75	12.625

Class 6000		1/8	1/4	3/8	1/2	3/4	1	1 1/4	1 1/2	2
	A	1 11/15	1 27/32	2	2 5/16	2 7/16	2 7/8	3	3 1/2	4 1/8
	B	1 31/64	1 11/16	1 15/16	2 3/8	2 25/32	3 23/64	3 23/32	4 27/64	5 15/64
	C	53/64	1	1 3/16	1 15/32	1 25/32	2 7/32	2 35/64	3 1/16	3 9/16
	D	25/32	31/32	1 3/32	1 5/32	1 3/8	1 45/64	1 7/8	2 1/16	2 3/8
	E	7/16	7/16	7/16	9/16	9/16	9/16	9/16	11/16	7/8
	F	0.42	0.555	0.69	0.855	1.065	1.33	1.675	1.915	2.406
	Weight/Union (lbs)	0.5	0.56	0.75	1.25	1.75	3	3.75	6	10.5

Socket Weld

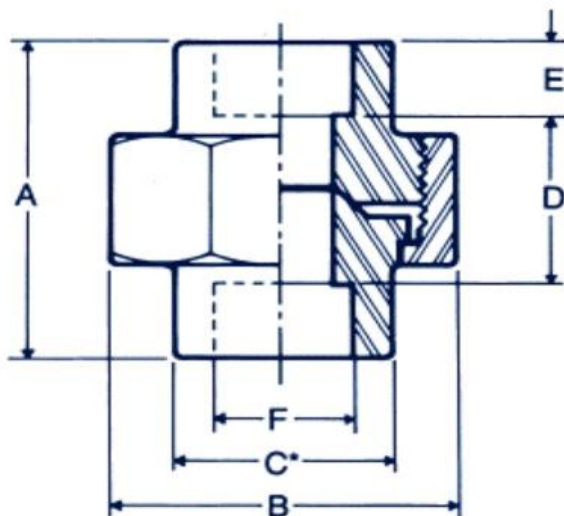

B & C DIMENSIONS ACROSS
OCTAGON CORNERS

* "C" dimension is across octagon corners or a diameter as applicable.
The 2 1/2" and 3" 3000 and 2" 6000 sizes have octagonal male and female ends; the other sizes are round.

