

UTDS46M Stainless Steel Thermodynamic Steam Trap for use with Pipeline Connectors

Description

The UTDS46M is a maintainable stainless steel thermodynamic steam trap with integral strainer, integral air vent, insulation cover and a replaceable seat to ease maintenance. It has been specifically designed for low capacity applications up to 667psig (46 bar g). The UTDS46M is attached to a suitable pipeline connector by two screws for quick and easy installation, maintenance and replacement.

Optional extra

At extra cost a **BDV2 integral blowdown valve** can be pre-fitted to the strainer cap but must be specified at the time of order placement.

Compliance

This product fully complies with the requirements of the European Pressure Equipment Directive 2014/68/EU.

Certification

This product is available with certification to EN 10204 3.1.

Note: All certification/inspection requirements must be specified at the time of order placement.

Pressure / temperature limits

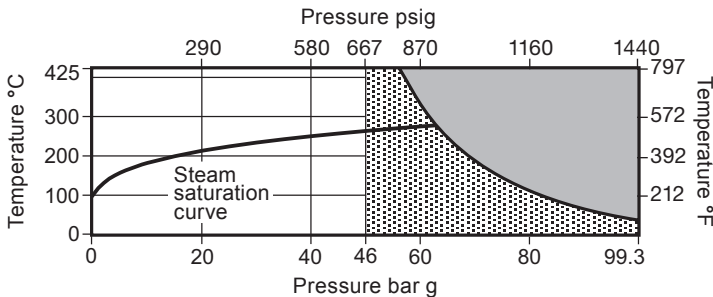

- The product **must not** be used in this region.
- The product **should not** be used in this region.

Note: The model of pipeline connector and connection selected will dictate the maximum operating limits of the complete assembly. Reference the specific pipeline connector Technical Information sheet as detailed in 'Pipeline connector options'.

Body design conditions	ASME Class 600
PMA Maximum allowable pressure	1440 psig @ 100°F (99.3 bar g @ 38°C)
TMA Maximum allowable temperature	797°F @ 812 psig (425°C @ 56 bar g)
Minimum allowable temperature	-40°F (-40°C)
PMO Maximum operating pressure	667 psig @ 797°F (46 bar g @ 425°C)
TMO Maximum operating temperature	797°F @ 667 psig (425°C @ 46 bar g)
Minimum operating pressure	22 psig (1.5 bar g)
Minimum operating temperature	32°F (0°C)
Note: For lower operating temperatures consult Spirax Sarco	
PMOB Maximum operating backpressure is	80% of the upstream pressure
Designed for a maximum cold hydraulic test pressure of	2161 psig (149 bar g)

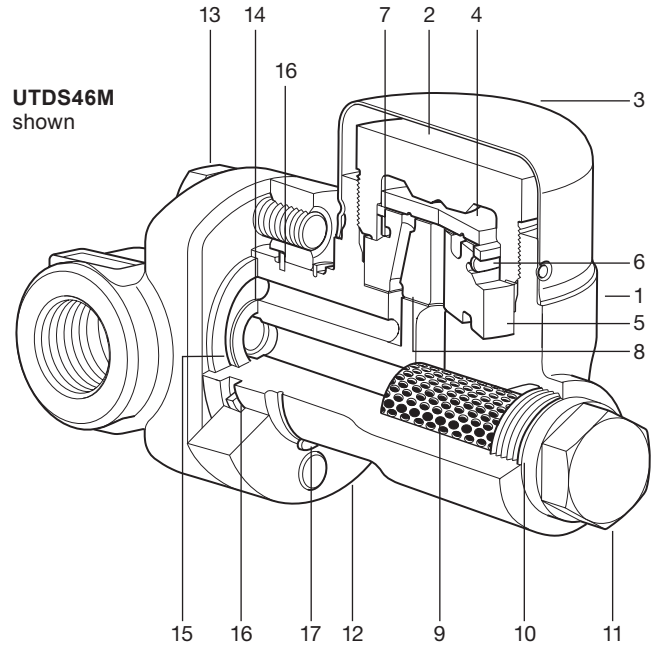

Materials

No.	Part	Material
1	Body	Stainless steel 1.4308/ASTM A351 CF8
2	Top cap	Stainless steel 1.4301/ASTM A479 304
3	Insulating cover	Stainless steel EN 10088-1 1.4301
4	Disc	Hardened steel 1.2379
5	Seat	Hardened steel 1.2379
6	Bimetal ring	Bimetal
7	Support	Stainless steel AISI 304
8	Seat gasket	Graphite foil
9	Strainer screen	Stainless steel A478 316L
10	Strainer cap gasket	Stainless steel AISI 304
11	Strainer cap	Stainless steel 1.4308/ASTM A351 CF8
12	Flange	Steel - ELNP ASTM A193 B7
13	Screws	Steel ASTM A193 B7
14	Inner gasket	Graphite/stainless steel laminate AISI 316 strip
15	Outer gasket	Graphite/stainless steel laminate AISI 316 strip
16	Split Ring	Stainless Steel ASTM A240 304
17	Crescent Ring	Carbon spring steel

Local regulation may restrict the use of this product below the conditions quoted. Limiting conditions refer to standard connections only.
In the interests of development and improvement of the product, we reserve the right to change the specification.

Capacities

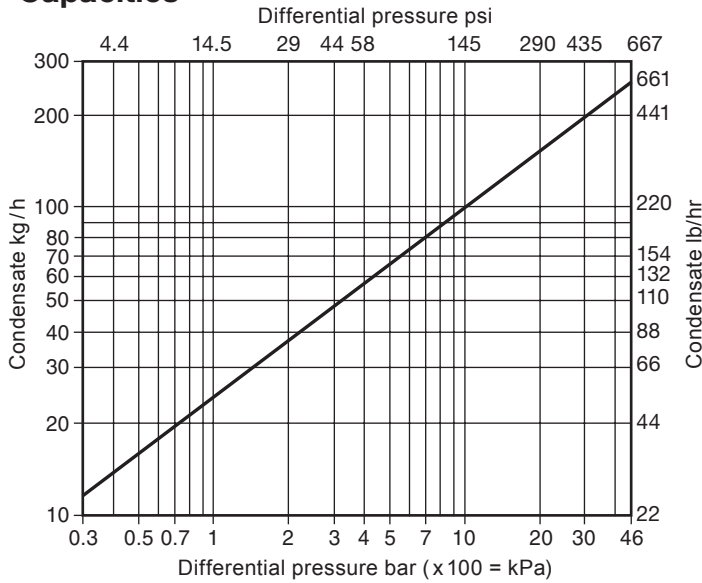

Dimensions

approximate in inches (mm)

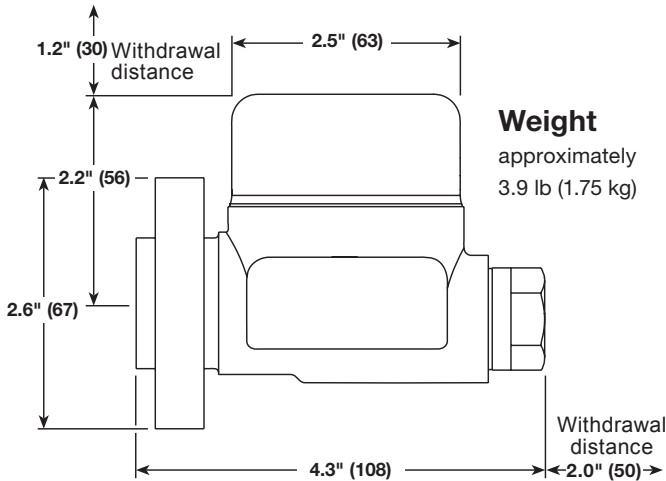

Safety information, installation and maintenance

For full details see the Installation and Maintenance Instructions (IM-P187-05) supplied with the product.

Installation note:

The UTDS46M is designed for installation with the disc in a horizontal plane with the insulating cover at the top.

It is recommended that a non-return valve is fitted when discharging condensate into return lines where backpressure is experienced. It is also recommended that a diffuser is fitted when discharging to atmosphere. For ease of maintenance, consideration should be given to fitting isolation valves upstream and downstream of the steam trap.

Spare parts

The spare parts available are shown in solid outline. Parts drawn in broken line are not supplied as spares.

Available spares

Insulating cover	3
Top cap, seat and disc assembly	2, 4, 5, 6, 7, 8
Strainer screen	9, 10
Set of gaskets (packets of 3 sets)	8, 10
Connector screws and gaskets	13, 14, 15
BDV2 blowdown valve retrofit kit	

How to order spares

Always order spares by using the description given in the column headed 'Available spares' and state the size and type of steam trap.

Example: 1 - Top cap, seat and disc assembly for a Spirax Sarco UTDS46M thermostatic steam trap.

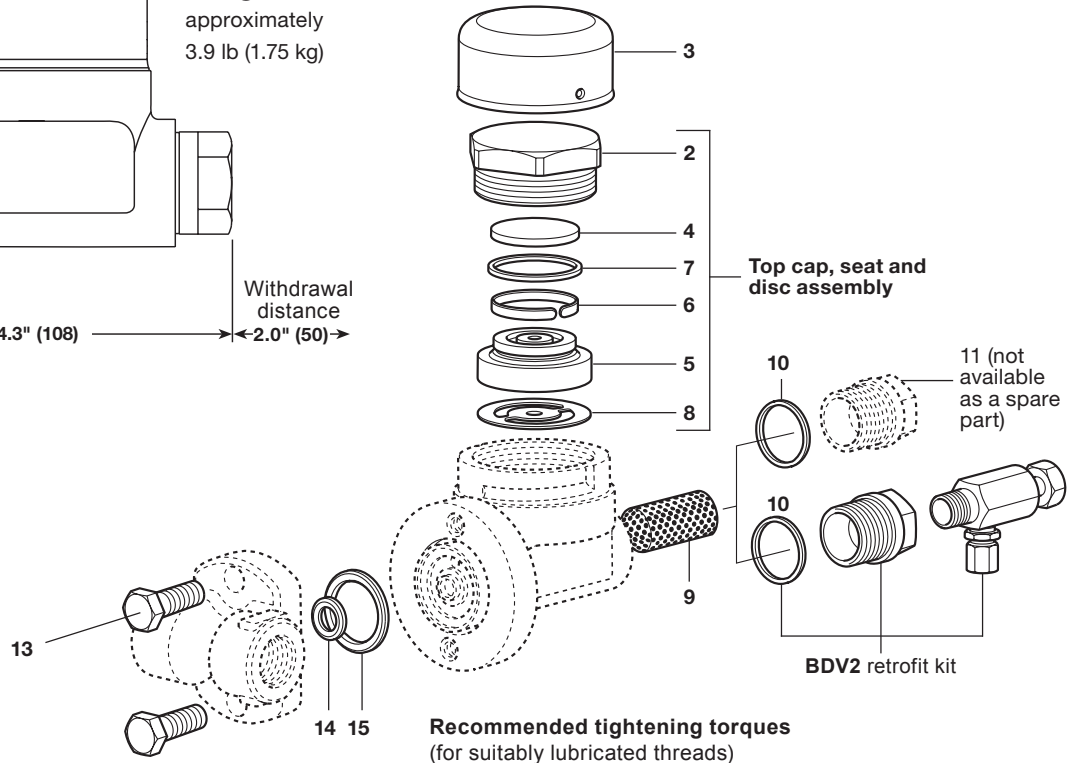

Recommended tightening torques

(for suitably lubricated threads)

Item	Part	mm	lb ft (Nm)
2	Top cap	50 A/F	221 (300)
11	Strainer cap	24 A/F	77-81 (105-110)
13	Connector screws	9/16" A/F	26 (35)

TI-P187-03-US 3.17

How to order example:

1 off Spirax Sarco UTDS46M thermostatic steam trap fitted with a BDV2 integral blowdown valve. The unit is supplied complete with connector screws and gaskets.