

MODEL BV435

Grooved End Stainless Steel Ball Valve with Lever Handle

The Model BV435 Grooved End Stainless Steel Ball Valves with Lever Handle provide for efficient control of fluid in piping systems. Flow may be from either direction, and the valves may be positioned in any orientation. The valves are furnished with grooved ends for use with Gruvlok grooved couplings. The handle is provided with a device for padlocking in either the open or closed position.

MAXIMUM WORKING PRESSURE: 600 psi (41.4 bar)

MATERIAL SPECIFICATIONS

BODY: Cast Stainless Steel per ASTM A351-CF8M

BALL: Cast Stainless Steel per ASTM A351-CF8M

UPPER STEMS: Stainless steel per ASTM A276, Type 316

OPERATOR: Stainless Steel Lever per ASTM A-276, Type 304

SEATS: 1½ to 3 Inches: Virgin PTFE, 4 Inches: Glass Filled PTFE

SEALS: PTFE

O-RINGS: EPDM

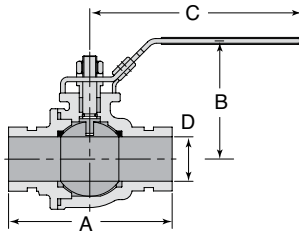

1 1/2 - 3" size



4" size

MODEL BV435 GROOVED END STAINLESS STEEL BALL VALVE NOMINAL PRESSURE LOSS VS FLOW

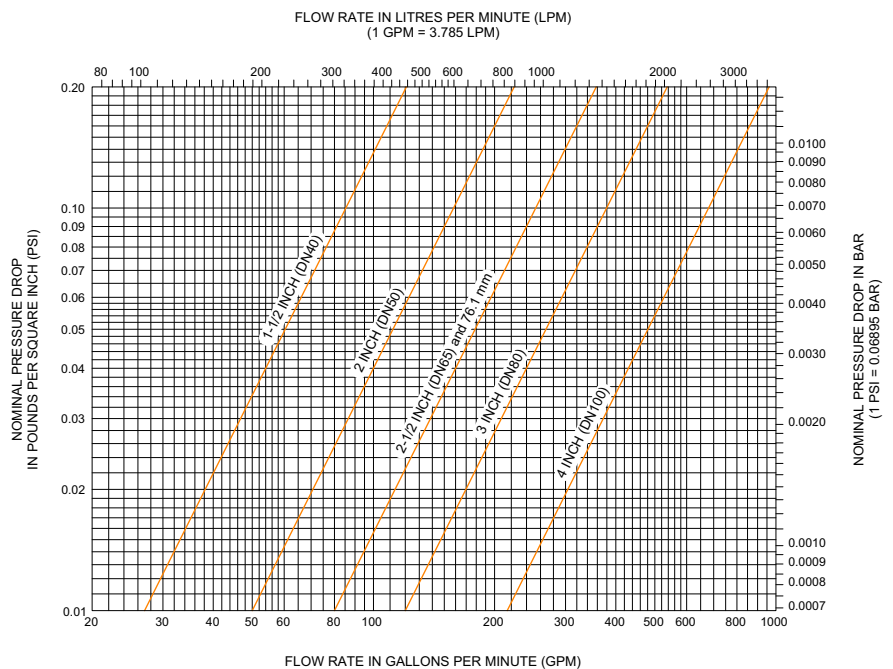

BV435 STAINLESS STEEL BALL VALVE								
Valve Size	O.D.	Dimensions				Operating Torque	Approx. Wt. Ea.	
		A	B	C	D			
in./mm	in./mm	in./mm	in./mm	in./mm	in./mm	in.-Lbs./Nm	Lbs./Kg	
1½	1.900	5.50	3.70	7.60	1.50	62	6.6	
40	48.3	140	94	193	38	7	3.0	
2	2.375	6.15	4.13	7.60	1.97	150	8.8	
50	60.3	156	105	193	50	17	4.0	
2½	2.875	7.09	4.33	9.84	2.36	186	15.4	
65	73.0	180	110	250	60	21	7.0	
3	3.500	8.42	6.00	9.84	2.99	248	20.7	
80	88.9	214	152	250	76	28	9.4	
4	4.500	9.45	6.57	11.42	3.94	398	55.0	
100	114.3	240	167	290	100	45	25.0	

Weight includes the lever handle.

PROJECT INFORMATION

APPROVAL STAMP

Project:	<input type="checkbox"/> Approved
Address:	<input type="checkbox"/> Approved as noted
Contractor:	<input type="checkbox"/> Not approved
Engineer:	Remarks:
Submittal Date:	
Notes 1:	
Notes 2:	